

New Hudson No. 1 Drain

The New Hudson No. 1 Drain is a chapter 4 drain established in 1904 and is approximately 18,525 feet of open ditch. The Drain has its outlet in the Novi and Lyons Drain in the SE $\frac{1}{4}$ of Section 8 in the Township of Lyon, west of Martindale Road and south of Pontiac Trail. From its outlet the drain extends northeasterly through section 8 and section 9 and crossing the SE $\frac{1}{4}$ of the SE. $\frac{1}{4}$ of section 4 and continuing northeasterly in section 3 to a point on the east side of the Grand Trunk Western Railroad approximately 200 feet south of Grand River Avenue; thence southeasterly crossing the south half of Section 3 and the NE $\frac{1}{4}$ of Section 10 and continuing southeasterly in the north half of Section 11 to its upper terminus at Grand River Avenue in the NE. $\frac{1}{4}$ of section 11 west of Haas Road.

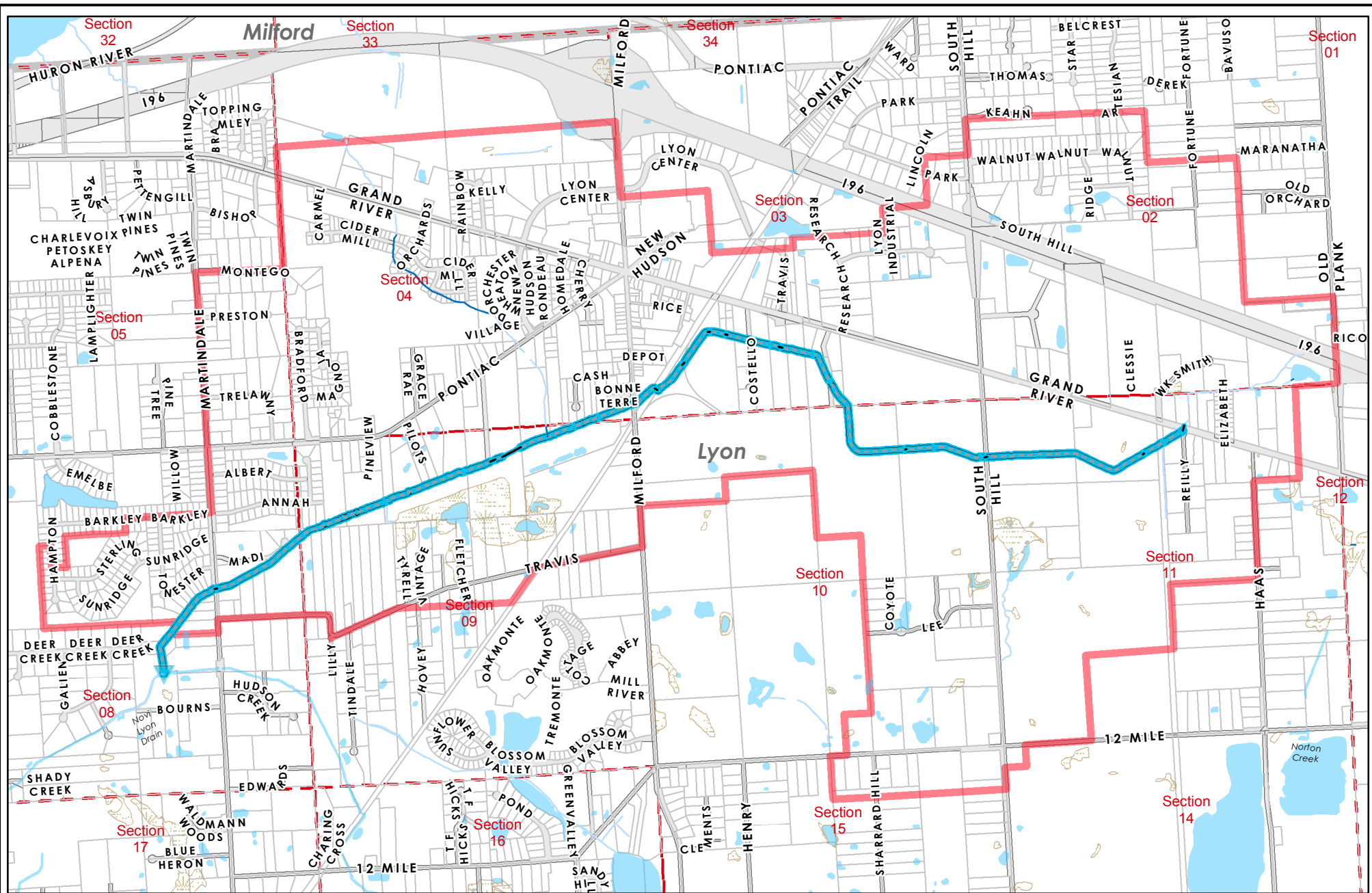

Legend

Lower Terminus	Force Main	Assessment District
Storm Pipe / Culvert	Private / Maintained by Others	Tax Parcel
Abandoned Storm Pipe / Culvert	Channel	Section Lines
Private / Maintained by Others	Spillway	Municipal District
NON WRC Culvert	Stream / River	
Siphon	Swamp / Marsh	
	Drain Detention / Retention Pond	
	Lake / Pond or Stream / River / Channel	

**NEW HUDSON NO. 1 DRAIN
DRAIN ASSESSMENT DISTRICT
TOWNSHIP OF LYON**

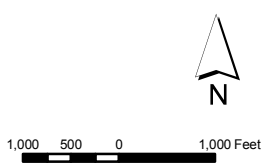

WRC
 WATER RESOURCES COMMISSIONER
John P. McCulloch

Disclaimer: The information provided in this system has been compiled from reported deeds, plats, tax maps, surveys and other public records and data. It is not a legally recorded map or survey and is not intended to be used as one. Users of this data are hereby notified that the information sources mentioned above should be consulted for verification of the information.